

Pneumatic Rotary Index Table - Series MRI

How to order

MRI

Series



180

Workplate size

Ø180
Ø250
Ø320

4

No. of division

4
6
8
12
24



Features

1. To reduce the impact, bumper is attached.
2. Tolerate heavy torque with no deviation.
3. Simple operation, the whole system can be controlled by air signal, hydraulic pressure signal or electrical signal.
4. Automate the production. To integrate with tapping machine, milling machine, riveting machine, air presses, and hydraulic presses.
5. Easy to adjust in standard divisions 4, 6, 8, 12, 24. Special divisions are available upon request.

Specification

	MRI-180	MRI-250	MRI-320
Operating fluid	Compressed air		
Operating pressure	0.49~0.69MPa(5~7kgf/cm ²)		
Rotary direction	Clockwise		
Tolerant loading capacity	50 kg	100 kg	200 kg
Weight	11 kg	28 kg	58 kg
Height	75 mm	104 mm	127 mm
Plate diameter	180 mm	250 mm	320 mm
Division type	Ratchet type		
Division part	4 6 8 12 24		
Division precision	±0.02 mm		
Max. plate diameter	280 mm	400 mm	600 mm
Cylinder dimension	Ø40X75	Ø63X100	Ø80X145

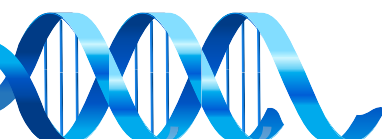

External dimensions

MRI180-

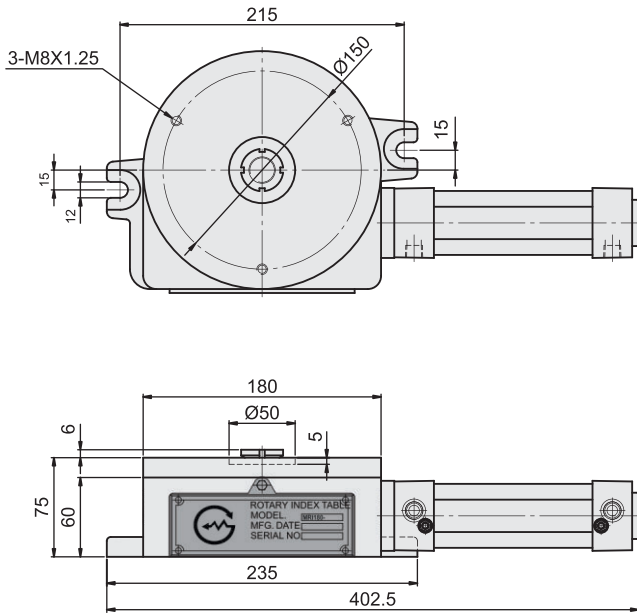

MRI250-

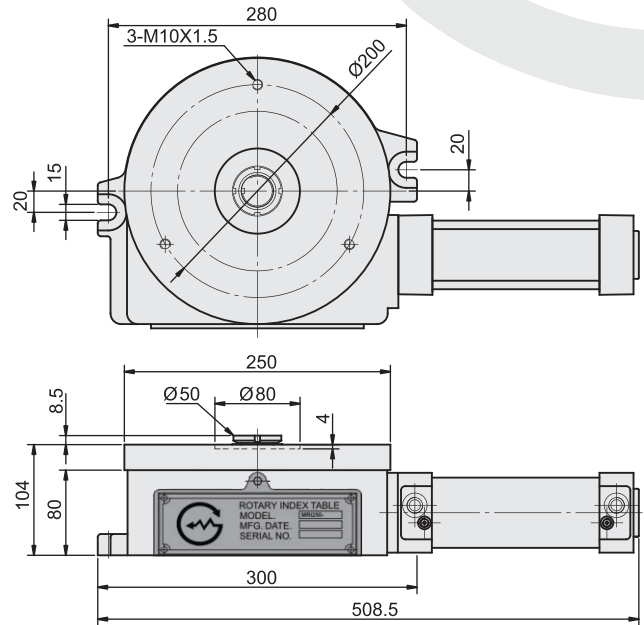

MRI320

